

UNITECHLINE™ AS 16 MM

PRESSURE-COMPENSATING,
CONTINUOUSLY SELF-CLEANING DRIPPER
ANTI-SIPHON MECHANISM



UNITECHLINE™ AS 16 MM

PRESSURE-COMPENSATING, CONTINUOUSLY SELF-CLEANING DRIPPER ANTI-SIPHON MECHANISM

APPLICATIONS

- Sub-surface and on-surface installation
- Slopes
- High wind areas
- Areas subject to vandalism
- Planting areas
- Curved, narrow and unshaped planting areas
- Turf, shrubs, trees and flowers
- Rooftop gardens
- Green walls
- Sports turf, tennis courts and golf courses
- High traffic/high liability areas
- Raised planters

SPECIFICATIONS

- Broadest choice of dripper flow rates: 1.0, 1.6, 2.3 l/h
- Dripper spacings: 0.3, 0.4, 0.5, 1.00 m
(Other dripper spacing available upon request)
- Pressure-compensating range: 0.5 - 4.0 bar
- Anti-Siphon mechanism
- Maximum system pressure: 4.0 bar
- Recommended filtration: 120 mesh
- Dripperline OD (outside diameter) : 16.6 mm
- Dripperline ID (inside diameter) : 14.2 mm
- Coil length: 25, 50, 100, 400 m

FEATURES & BENEFITS

Pressure compensating

- Precise and equal amounts of water are delivered over a broad pressure range
- 100 % uniformity of water and nutrients distribution along the laterals

Continuous self-flushing dripper design

- Flushes debris as it is detected, throughout operation, not just at the beginning or end of a cycle, ensuring uninterrupted dripper operation

Anti-Siphon mechanism

- Anti-Siphon mechanism prevents contaminants from being drawn into the dripper

Unique dripper design with

- Physical root barrier: better protection against root intrusion without reliance on chemicals
- Largest filter in each dripper
- Widest water passages within the dripper
- Unique TurboNet™ flow path

Dripper position within the dripperline

- The water is drawn in to the dripper from the stream center, preventing the entrance of sediments in to the drippers

Flexible tubing

- Adapts to any planting area shape

UV resistant

- Withstands heat and direct sun - for on-surface installations

Single hole dripper outlet from tubing

- Better protection against root intrusion



UNITECHLINE™ AS 16 MM

PRESSURE-COMPENSATING, CONTINUOUSLY SELF-CLEANING DRIPPER
ANTI-SIPHON MECHANISM

SUB- AND ON-SURFACE DRIPPERLINE FOR

- Slopes
- High wind
- Roof gardens
- Curved, narrow and unshaped areas

ANTI-SIPHON MECHANISM

The anti-siphon mechanism blocks contaminants from being drawn in to the dripper from outside, making it the ideal dripperline for sub-surface installations

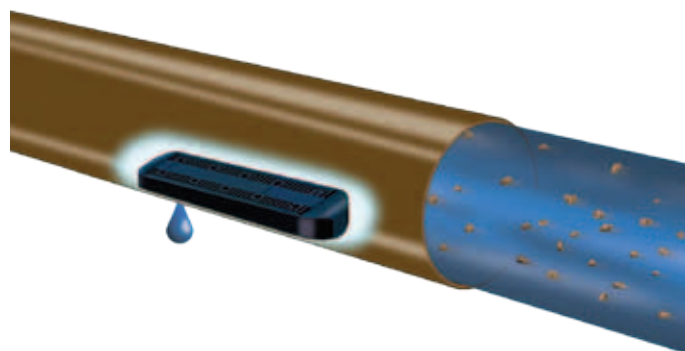

Water flows through the tubing and enters the dripper through the inlet filter. The filter blocks dirt and debris from entering, ensuring only clean water enters the dripperline.

EXPLODED VIEW OF UNITECHLINE™ AS DRIPPER

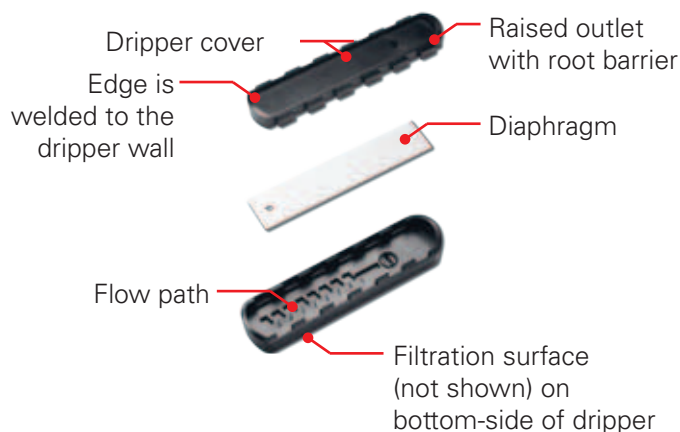

UNITECHLINE™ AS 16 MM

PRESSURE-COMPENSATING, CONTINUOUSLY SELF-CLEANING DRIPPER
ANTI-SIPHON MECHANISM

UniTechline™ AS 16012 • Drippers technical data

FLOW RATE L/H	WORKING PRESSURE RANGE (BAR)	WATER PASSAGE DIMENSIONS (MM)			FILTRATION AREA (MM²)	CONSTANT K	EXPONENT*
		WIDHT	DEPHT	LENGTH			
1.0	0.5 – 4.0	0.83	0.74	40	130	1.0	0
1.6	0.5 – 4.0	1.26	0.70	40	130	1.6	0
2.3	0.5 – 4.0	1.26	1.00	40	130	2.3	0

*Within working pressure range.

UniTechline™ AS 16012 • Flow liter/hour per 100 m

DRIPER SPACING (M.)	DRIPPER FLOW RATE (L/H.)		
	1.0	1.6	2.3
0.3	333.3	533.3	766.7
0.4	250.0	400.0	575.0
0.5	200.0	320.0	460.0
1.0	100.0	160.0	230.0

UniTechline™ AS 16012 • Max. lateral length • I.D. Ø 14.20 mm • Inlet pressure 3.0 bar

FLOW RATE (L/H)	SPACING BETWEEN DRIPPERS (M)			
	0.3	0.4	0.5	1.0
1.0	189	243	294	515
1.6	139	178	216	380
2.3	109	141	171	301

Calculated on a plain area. Minimum pressure considered: 0.5 bar. For more information, please contact Netafim™ technical support.

UniTechline™ AS 16012 • Dripperline technical data

MODEL	INSIDE Ø (MM)	WALL THICKNESS (MM)	OUTSIDE Ø (MM)	MAX. WORKING PRESSURE (BAR)	KD
16012	14.20	1.2	16.60	4.0	1.3